

## Installation procedure

- 1) Approved substrate must be dry and free of dust or any other “bond breaking” materials.
- 2) Cut and remove C-Mesh on the back of shape along entire length approximately 3/4” from the top and bottom for adhesive attachment. Refer to appropriate substrate detail for specific recommendations.

EIFS - Detail ‘A’

Masonry - Detail ‘B’

Stucco/Cement Plaster - Detail ‘C’

Miter Joint - Detail ‘D’

- 3) Apply approved adhesive to back of Canamould shape using 3/8” notched trowel. (Vertical pattern recommended)
- 4) While adhesive is wet, immediately install Canamould shape and press into place. Remove excess adhesive before it dries.
- 5) Some pieces may require mechanical attachment until adhesive sets up. For external temporary attachment the Windlock 302 plate or equal with appropriate fastener may be used and then removed prior to the finish coat. For “blind” mechanical attachment into masonry, a stub nail driven into the surface will serve as a temporary hold until the adhesive cures. For “blind” attachment into EIFS, use the Windlock M-1090 insul-tac as a temporary hold until the adhesive cures.
- 6) When joining two pieces together use either a miter cut or straight cut. Check alignment of joint for proper fit prior to embedding Cana-Mesh with approved basecoat over joints.



### 6a. Spline Detail

The following spline detail may be used in lieu of surface/(face) meshing (see 6).

1. Groove insulation board directly behind basecoat (Figure #1) using Wind-lock's™ QC Hot Knife with a I-CANB blade. (Note: for larger pieces groove the EPS board in the middle of the shape also, for more bite.)
2. Apply fibered adhesive mix to both sides. (Figure #2)
3. Press both pieces together and “finger tool” the joint smooth. (Figure #3)



### 7. Prior to applying finish, ensure that:

- a. All shapes are completely adhered and fully cured
- b. All temporary fasteners are removed.
- c. All joints have been treated and sanded flush.
- d. All Canamould™ surfaces are clean and free of dirt, dust and other contaminants.

### EIFS - Detail A

Install system mesh as per EIFS manufacturer's recommendations

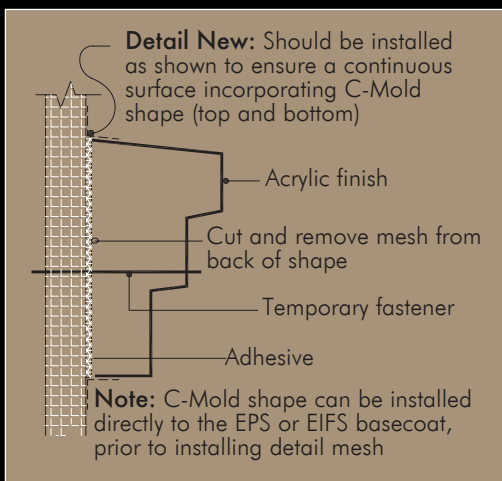

### MASONRY - Detail B

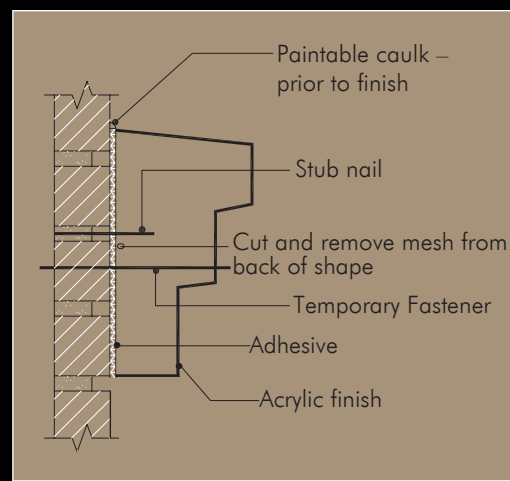

### STUCCO/ CEMENT/PLASTER Detail C

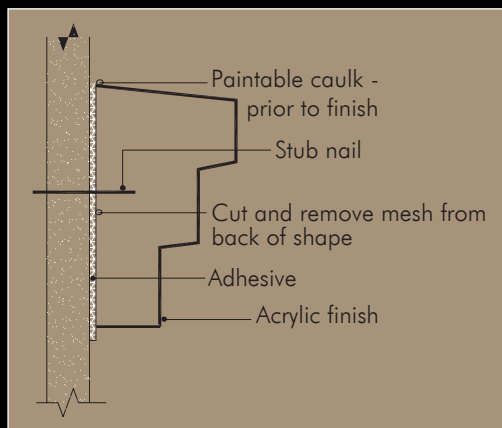

substrate      adhesive